

Proposal for a new Lode Heath Community Leisure Facility



- Disposal of a 0.94 ha. parcel of land off Rowood Drive, Lode Heath
- Land is owned by the Council, but is subject to a 125 year lease to the school
- Land surplus to requirements as the school has sufficient high standard outdoor facilities
- Land been unused for over 20 years because of its distance from the main school site and road safety issues
- Anti –social behaviour incidents on the land are increasingly frequent and of concern to local residents
- We propose to use the capital receipts from the sale of the site to replace the existing outdated gymnasium with modern and enhanced multi-use facilities., for both the school and wider community use



Rowood Drive Site

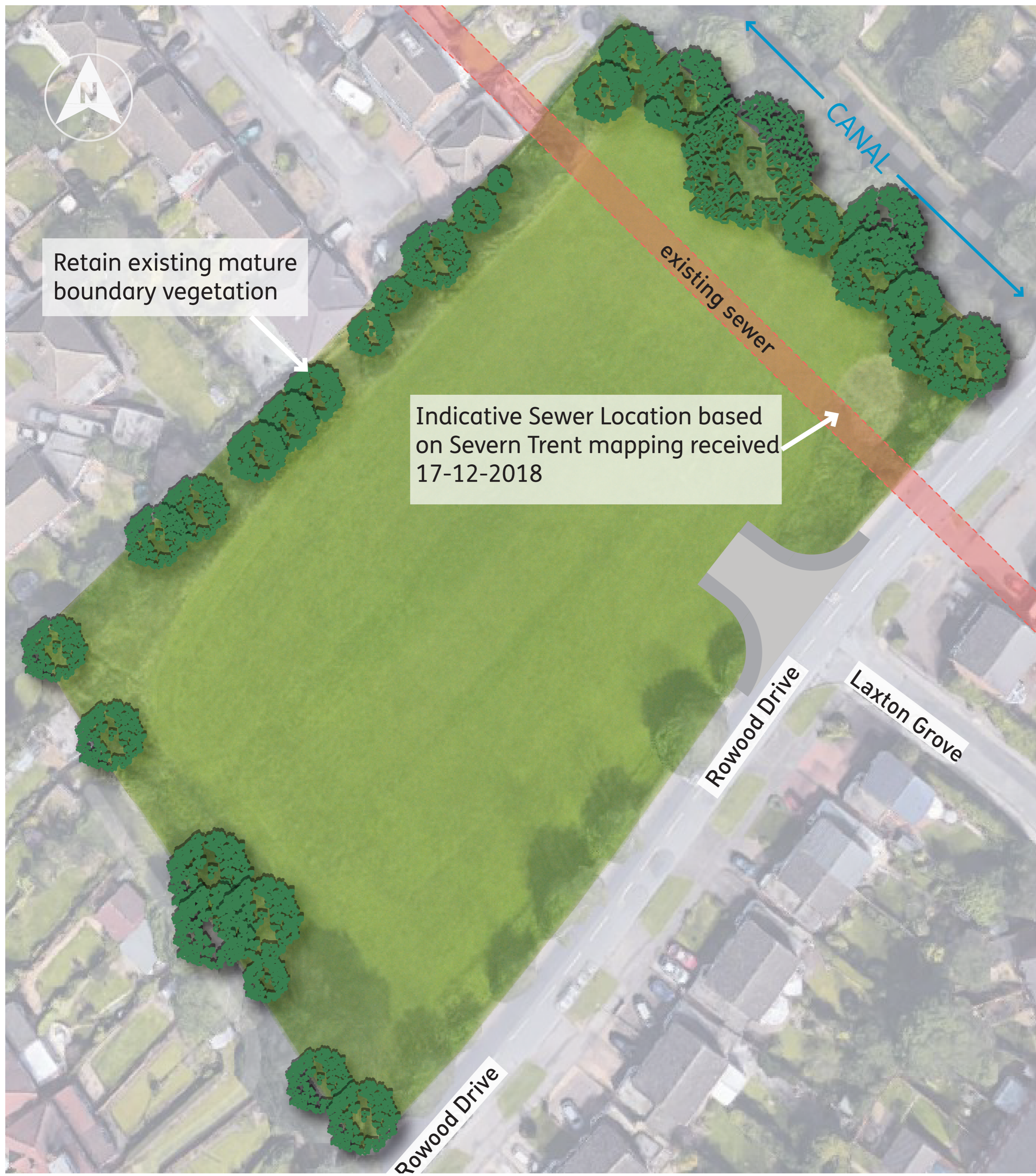

Existing Gymnasium



Existing gymnasium exterior



Existing gymnasium exterior



Existing gymnasium exterior



Existing gymnasium interior



Existing changing facilities

- The school gymnasium was built during the 1950's
- Is increasingly obsolete and ill-suited to modern day needs and usage
- The floor is in need of repair as it is a wooden composition with a mixture of old and new sections
- The sports hall has limited functional space
- Limited facilities to cater for a broader range of different activities and user groups
- Existing wall bars and beams are now out-dated and restrict alternative uses
- The low ceiling in the gym precludes its use for trampoline sports both for the school and the community. It needs to be at least 5.18 m high to allow this activity



Our Vision for a New Community Leisure Facility

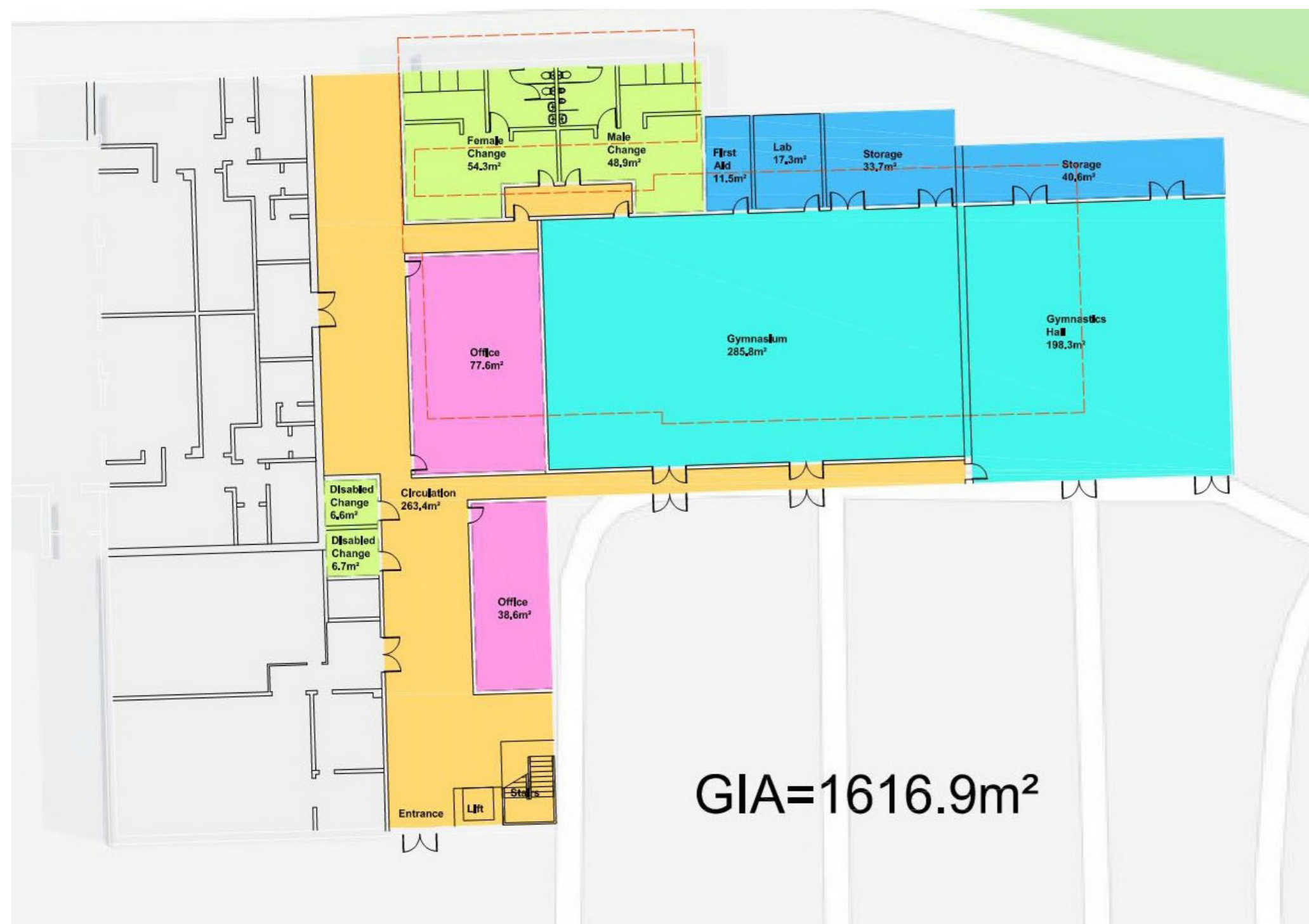

Indicative Ground Floor Plan



Indicative First Floor Plan

- Provision for a wider range of uses with significant benefits for both the school and wider community
- New facility will support a significant increase in physical participation levels across all age groups, including the elderly
- Primary age children from the Lode Heath primary feeder schools would have access to the facility
- New trampoline facility will support the development of physical activity for all members of the school community from 11-18 years of age
- Improved changing facilities will help optimise the use of the school's wider sporting offer for all age groups
- The Science and Sports Specialism capability of the school would be enhanced
- Community Use Agreement: Creation of meeting rooms for the community and facilities for use by local sports clubs



Example of gymnasium exterior



Example of gymnasium interior



Example of gymnasium interior

